

# STUDYING TOGETHER: SABBATH

**Bible study groups begin at 10:00am and meet in a variety of locations** (see map below). You're invited to attend any of the groups studying a wide variety of topics.

**Children's classes** meet in the east wing of our facility (except for the teens who meet in the Youth Chapel) and provide a great opportunity for your child to learn more about Jesus in a warm and safe environment.

**An offering** is taken during our study time and supports various mission projects as well as providing study materials for all age groups on Sabbath mornings.

## STUDY GROUP LOCATIONS

*Whether you're a member or a guest, you're invited to attend any of the study groups:*

- **A Conversation About the Scriptures:** January 31st and February 7th - How to understand "God's Wrath". February 14th and 21st "Unanswered Prayers." February 28th and March 7th - What happened at the Cross? - The Atonement. (Team led by Jim Brewster/Jeff Pierson/Brian Toppel in Fellowship Hall-room #1)
- **Adult Quarterly: The Book of Proverbs:** The Book of Proverbs teaches about what it means to follow God in our daily lives. Proverbs provides down-to-earth advice for daily living. (A: Left rear of Sanctuary—Teacher: Norman Herron B: Front right of Sanctuary— Teachers: Mike Wood)

# WORSHIP SERVICE

January 31, 2015

11:15am - 12:30pm

## We Gather For Worship

Children's Story

Dave Carreon

Worship in Giving

Jim Brewster

Church Family Budget

Worship in Prayer

Steve Holm

Today's Message

Dan Appel

*"What's a Body To Do?"*

## TO GET THE MOST OUT OF WORSHIP TODAY WE RECOMMEND:

- ~ **Fill out the Welcome Card located in front of you as you sit down.** It will help us become better acquainted and allow you to communicate with us your needs and/or request information. Just check the appropriate boxes and be sure to write your name and contact info so that we can follow up and simply place the card in the offering plate.
- ~ **Be respectful of others** by turning off or silencing your cell phone.
- ~ **Please don't feel obligated to participate in the offering.** The offering is intended for members and regular attenders who consider Auburn their church home. As our guest, we ask only that you place your Welcome Card in the offering plate when it is handed to you.
- ~ **Nursing mothers** may care for their child in the Mother's Room located off to the left of the Sanctuary.
- ~ **Hearing assistance** is available. Please ask at the sound booth for an amplifier.

map

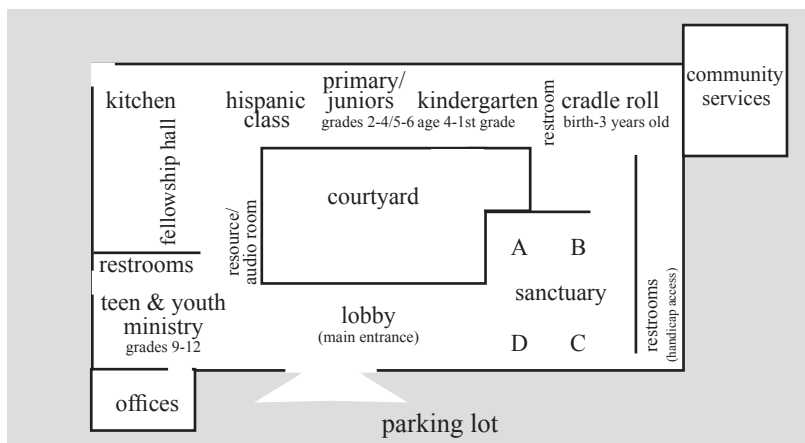

**Financial Report**  
2014-15 fiscal year:  
as of January 24, 2015, week 30

**Church Family Budget**

Received: \$106,784.50  
Needed: \$102,692.31

**Building Fund**

Goal \$50,000.00

Received: \$45,550.83  
Needed to reach goal: \$ 4,449.17

**Student Assistance Fund**

Received: \$ 13,081.00  
Needed: \$14,423.08

Next week's offering is for Adventist Television Ministries

**CHURCH STAFF**

Dan Appel, Senior Pastor	(530)392-3428
David Carreon, Associate Pastor	(530)852-4770
Jim Brewster, Admin Pastor	(530)887-1655
Tulio Robinson, Head Elder	(530)885-4232
Kathy Brewster, Church Clerk	(530)887-1655
Vic Anderson, Principal (PHAA)	(530)885-9447
Kendall Porco, Community Services	(530)823-0345
Norman Herron, Head Deacon	(530)820-3573
Rodney Wehtje, Finance Chair	(530)885-4232
Jenell Wareham, Treasurer	(530)885-4232
Community Services	(530)823-0345
Auburn Renewal Center	(530)887-8673



---

BECAUSE WE BELIEVE JESUS IS RETURNING, OUR MISSION IS:  
TO ATTRACT AND GROW PASSIONATE FOLLOWERS OF JESUS THROUGH  
WORSHIP, RELATIONSHIPS, AND SERVICE.

---

THE CARING CHURCH

IF THIS IS NOT A PLACE  
WHERE TEARS ARE UNDERSTOOD,  
WHERE DO I GO TO CRY?

IF THIS IS NOT A PLACE  
WHERE MY SPIRIT CAN TAKE WING,  
WHERE DO I GO TO FLY?

IF THIS IS NOT A PLACE  
WHERE MY QUESTIONS CAN BE ASKED,  
WHERE DO I GO TO SEEK?

IF THIS IS NOT A PLACE  
WHERE MY FEELINGS CAN BE HEARD,  
WHERE DO I GO TO SPEAK?

IF THIS IS NOT A PLACE  
WHERE YOU'LL ACCEPT ME AS I AM,  
WHERE DO I GO TO BE?

IF THIS IS NOT A PLACE  
WHERE I CAN TRY AND LEARN AND GROW,  
WHERE CAN I JUST BE ME?

OUR DREAM IS THAT THE AUBURN ADVENTIST CHURCH CAN BE A PLACE  
WHERE PEOPLE, HURT AND DAMAGED BY LIFE AND BY RELIGION, CAN MEET  
JESUS AND COMMIT TO FOLLOWING HIM. WE INVITE YOU TO JOIN US IN DIS-  
COVERING HIS POWER TO HEAL ALL OF OUR PAIN AND DYSFUNCTION AND TO  
MAKE US MORE THAN WE HAVE EVER DREAMED THAT WE COULD BE.

# FOR YOUR INFORMATION

**SERVICIO EN ESPANOL** comienza a las 9:30am hasta las 11:00am Escuela Sabatica. Culto Divino alas 11:15am hasta las 12:30pm. (meets in the Hispanic Class Room) Para mas informacion

**CHURCH ELDERS** will be at the front of the church immediatly following each Worship Service to pray with anyone who may wish to do so.

**NEXT FELLOWSHIP LUNCH** Our next Fellowship Lunch will be February 14, 2015.

**CELEBRATE RESTORATION AND RENEWAL (CRR)** A time and place to discover God's power to restore and renew you - no matter the pain that you feel, the problems life has dealt you or the habits which chain you. Fridays from 7pm-8:30pm here at the church.

**WORSHIP SERVICE RECORDINGS** are available in the Resource Center following today's service. CD's are \$4.00ea. You may also find them online at our church webpage under "media library" as downloads or streaming.

**LIVE-STREAMING** of our worship service can be viewed by going to [www.aubsda.org](http://www.aubsda.org) and click on "church service live". Previously recorded services are also available.

**MINISTRY OPPORTUNITIES** A Sabbath School Secretary Assistant is needed for once a quarter on the 5th Sabbath of the month. This is a once a quarter service duty of about 25 minutes to help with Sabbath School attendance records. You would need to be at the church by 9:45am. See Kathy Brewster in the Resource Center.

**FEBRUARY NEWSLETTER** Pick up a copy of the February Newsletter in the Lobby.

**NCC WOMEN'S MINISTRIES CONFERENCE** The Northern California Conference Women's Ministries department is planning a Women in Service and Leadership Conference on February 27 and February 28 at the Orangevale Seventh-day Adventist Church. Brochure/application forms can be found on the cradenza in the lobby.

**SWEETHEART VALENTINE'S DAY DINNER** The Auburn Pathfinder Club is sponsoring a Sweetheart Valentine's Day Dinner in the Fellowship Hall on February 14 at 5:30pm. The only thing you need to bring is your sweetheart. If you plan to come, please send your reservation to Dave Carreon at [david.carreon@nccsda.com](mailto:david.carreon@nccsda.com).

**CHURCH JANITOR NEEDED** We will have an opening for a church janitor beginning the second week of February. Duties include cleaning of restrooms, vacuuming, and general cleaning. Approximately 6 to 8 hours per week. If you would have an interest in applying for the position, please contact the church office.

**100TH BIRTHDAY** Betty Foster, Pam Mamoulelis' mother will be 100 years old on February 7. If you know her and would like to send a card or greetings, you can send it in care of Pam at 12041 Westwood Drive, Auburn, CA 95602.

## AUBURN RENEWAL CENTER CLINIC HOURS

Tuesday, February 3, 2015 - 9:00am - 1:00pm

Tuesday, February 10, 2015 - 9:00am - 1:00pm

Saturday, February 14, 2015 - 2:00pm - 6:00pm

# CALENDAR FEBRUARY 1, 2015 - FEBRUARY 14, 2015

SUNDAY	1		SUNDAY	8	
MONDAY	2		MONDAY	9	
TUESDAY	3	Community Services 9:00am - 1:00pm Auburn Renewal Center 9:00am - 1:00pm	TUESDAY	10	Community Services 9:00am - 1:00pm Auburn Renewal Center 9:00am - 1:00pm
WEDNESDAY	4	5:30pm - Common Links	WEDNESDAY	11	5:30pm - Common Links
THURSDAY	5	Volleyball PHAA 6:00pm - 9:00pm	THURSDAY	12	Volleyball PHAA 6:00pm - 9:00pm
FRIDAY	6	7:00pm - Celebrate Recovery 5:30pm - Sabbath Begins	FRIDAY	13	7:00pm - Celebrate Recovery 5:38pm - Sabbath Begins
SABBATH	7	8:30am Community Breakfast 10:00am - Sabbath School 11:15 - Worship Service Dan Appel	SABBATH	14	8:30am Community Breakfast 10:00am - Sabbath School 11:15 - Worship Service Dan Appel & Dave Carreon
		5:31pm- Sabbath Ends			5:39pm- Sabbath Ends