

STUDYING TOGETHER: SABBATH

Bible study groups begin at 10:00am and meet in a variety of locations (see map below). You're invited to attend any of the groups studying a wide variety of topics.

Children's classes meet in the east wing of our facility (except for the teens who meet in the Youth Chapel) and provide a great opportunity for your child to learn more about Jesus in a warm and safe environment.

An offering is taken during our study time and supports various mission projects as well as providing study materials for all age groups on Sabbath mornings.

STUDY GROUP LOCATIONS

Whether you're a member or a guest, you're invited to attend any of the study groups:

- **A Conversation About the Scriptures:** January 17th & 24th - Principles of Bible Study. January 31st and February 7th - How to understand "God's Wrath". January 14th & 21st "Unanswered Prayers".
(Team led by Jim Brewster/Jeff Pierson/Brian Toppel in Fellowship Hall-room #1)
- **Adult Quarterly: The Book of Proverbs:** The Book of Proverbs teaches about what it means to follow God in our daily lives. Proverbs provides down-to-earth advice for daily living. (A: Left rear of Sanctuary—Teacher: Norman Herron B: Front right of Sanctuary— Teachers: Mike Wood)

WORSHIP SERVICE

January 17, 2015

11:15am - 12:30pm

We Gather For Worship

Children's Story

Gillian Fralick

Worship in Giving

Finance Committee

Church Family Budget

Worship in Prayer

Jeff Pierson

Today's Message

Dan Appel

"How do I Love You, Let me Show you the Ways"

John 13:35

TO GET THE MOST OUT OF WORSHIP TODAY WE RECOMMEND:

- ~ **Fill out the Welcome Card located in front of you as you sit down.** It will help us become better acquainted and allow you to communicate with us your needs and/or request information. Just check the appropriate boxes and be sure to write your name and contact info so that we can follow up and simply place the card in the offering plate.
- ~ **Be respectful of others** by turning off or silencing your cell phone.
- ~ **Please don't feel obligated to participate in the offering.** The offering is intended for members and regular attenders who consider Auburn their church home. As our guest, we ask only that you place your Welcome Card in the offering plate when it is handed to you.
- ~ **Nursing mothers** may care for their child in the Mother's Room located off to the left of the Sanctuary.
- ~ **Hearing assistance** is available. Please ask at the sound booth for an amplifier.

map

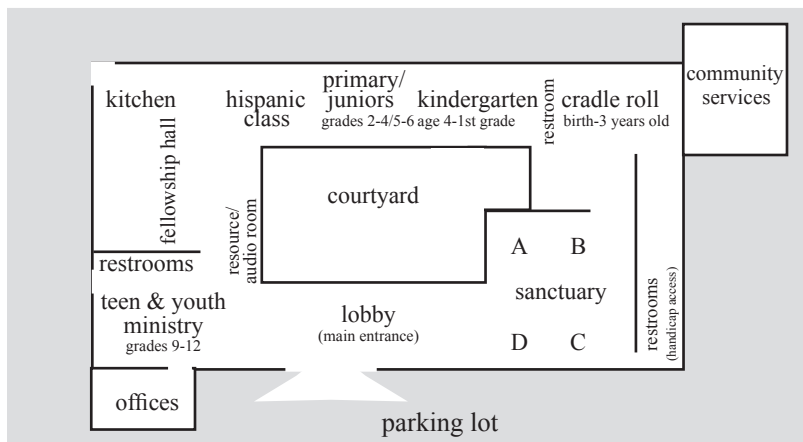

Financial Report
2014-15 fiscal year:
as of January 10, 2015, week 28

Church Family Budget

Received: \$105,400.24
Needed: \$ 95,846.15

Building Fund

Goal \$50,000.00

Received: \$45,425.83
Needed to reach goal: \$ 4,574.17

Student Assistance Fund

Received: \$12,731.00
Needed: \$13,461.54

Next week's offering is for Religious Liberty

CHURCH STAFF

Dan Appel, Senior Pastor	(530)392-3428
David Carreon, Associate Pastor	(530)852-4770
Jim Brewster, Admin Pastor	(530)887-1655
Tulio Robinson, Head Elder	(530)885-4232
Kathy Brewster, Church Clerk	(530)887-1655
Vic Anderson, Principal (PHAA)	(530)885-9447
Kendall Porco, Community Services	(530)823-0345
Norman Herron, Head Deacon	(530)820-3573
Rodney Wehtje, Finance Chair	(530)885-4232
Jenell Wareham, Treasurer	(530)885-4232
Community Services	(530)823-0345
Auburn Renewal Center	(530)887-8673



BECAUSE WE BELIEVE JESUS IS RETURNING, OUR MISSION IS:
TO ATTRACT AND GROW PASSIONATE FOLLOWERS OF JESUS THROUGH
WORSHIP, RELATIONSHIPS, AND SERVICE.

THE CARING CHURCH

IF THIS IS NOT A PLACE
WHERE TEARS ARE UNDERSTOOD,
WHERE DO I GO TO CRY?

IF THIS IS NOT A PLACE
WHERE MY SPIRIT CAN TAKE WING,
WHERE DO I GO TO FLY?

IF THIS IS NOT A PLACE
WHERE MY QUESTIONS CAN BE ASKED,
WHERE DO I GO TO SEEK?

IF THIS IS NOT A PLACE
WHERE MY FEELINGS CAN BE HEARD,
WHERE DO I GO TO SPEAK?

IF THIS IS NOT A PLACE
WHERE YOU'LL ACCEPT ME AS I AM,
WHERE DO I GO TO BE?

IF THIS IS NOT A PLACE
WHERE I CAN TRY AND LEARN AND GROW,
WHERE CAN I JUST BE ME?

OUR DREAM IS THAT THE AUBURN ADVENTIST CHURCH CAN BE A PLACE
WHERE PEOPLE, HURT AND DAMAGED BY LIFE AND BY RELIGION, CAN MEET
JESUS AND COMMIT TO FOLLOWING HIM. WE INVITE YOU TO JOIN US IN DIS-
COVERING HIS POWER TO HEAL ALL OF OUR PAIN AND DYSFUNCTION AND TO
MAKE US MORE THAN WE HAVE EVER DREAMED THAT WE COULD BE.

FOR YOUR INFORMATION

SERVICIO EN ESPANOL comienza a las 9:30am hasta las 11:00am Escuela Sabatica. Culto Divino alas 11:15am hasta las 12:30pm. (meets in the Hispanic Class Room) Para mas informacion **CHURCH ELDERS** will be at the front of the church immediatly following each Worship Service to pray with anyone who may wish to do so.

NEXT FELLOWSHIP LUNCH Our next Fellowship Lunch will be February 14, 2015.

CELEBRATE RESTORATION AND RENEWAL (CRR) ~A time and place to discover God’s power to restore and renew you - no matter the pain that you feel, the problems life has dealt you or the habits which chain you. Fridays from 7pm-8:30pm here at the church.

WORSHIP SERVICE RECORDINGS are available in the Resource Center following today’s service. CD’s are \$4.00ea. You may also find them online at our church webpage under “media library” as downloads or streaming.

LIVE-STREAMING of our worship service can be viewed by going to www.aubsda.org and click on “church service live”. Previously recorded services are also available.

JANUARY NEWSLETTER Pick up a copy of the January Newsletter in the Lobby.

GAME NIGHT Please join us for a family Game Night tonight at 6:00pm. Bring your favorite cheese for toasted cheese sandwiches and a favorite Board Game or puzzle. Beverages, bread, fruit, chips, and popcorn will be provided. Also, bring one or more cans of food for our Community Services Food Closet.

VISITATION REQUEST - Junan Larson a resident of Westview Healthcare Center, 12225 Shale Ridge Lane, Room 328B has requested visitation and Bible Study. If you would have an interest in this ministry, please contact the church office.

TEACHER'S AIDE NEEDED Pine Hills Adventist Academy is looking for a part-time (20-27 hours per week) Teacher's Aide. No teaching experience necessary. Please call the office at 530-885-9447 if you would like to apply or have any questions.

2014 OFFERING RECEIPTS The 2014 Offering Receipts are available in the Resource Center. Stop by and pick yours up.

MEMBERSHIP TRANSFERS:

Final Reading

Transfer In: Norm and Betty Henderson from Lakeport SDA, Lakeport, CA

AUBURN RENEWAL CENTER CLINIC HOURS

Tuesday, January 20, 2015 - 9:00 - 1:00pm

Saturday, January 24, 2015 - 2:00pm - 6:00pm

Tuesday, January 27, 2015 - 9:00am - 1:00pm

CALENDAR JANUARY 18, 2015 - JANUARY 31, 2015

SUNDAY	18	SUNDAY	25
MONDAY	19	MONDAY	26
TUESDAY	20	TUESDAY	27
WEDNESDAY	21	WEDNESDAY	28
THURSDAY	22	THURSDAY	29
FRIDAY	23	FRIDAY	30
SABBATH	24	SABBATH	31

6:00pm - Church Board

Community Services
9:00am - 1:00pm
Auburn Renewal Center
9:00am - 1:00pm

Community Services
9:00am - 1:00pm
Auburn Renewal Center
9:00am - 1:00pm

Volleyball PHAA
6:00pm - 9:00pm

Volleyball PHAA
6:00pm - 9:00pm

7:00pm - Celebrate Recovery
5:14pm - Sabbath Begins

7:00pm - Celebrate Recovery
5:22pm - Sabbath Begins

8:30am Community Breakfast
10:00am - Sabbath School
11:15 - Worship Service
Dave Appel
5:15pm- Sabbath Ends

8:30am Community Breakfast
10:00am - Sabbath School
11:15 - Worship Service
Dan Appel
5:23pm- Sabbath Ends